

Material:

Housing: High temperature housing withstands IR and VPR soldering methods.

Contacts: Phosphor Bronze.

Plating: Gold plated over nickel.

Tin plated over nickel.

Current Rating: 1 AMP.

Insulator Resistance: 5000MΩmin. at DC 500V.

Contact Resistance: 20mΩmax. at DC 100mA.

Operating Temperature: -65°C ~ +125°C.

Max Processing Temperature: 230°C for 30~60 seconds.

Features:

- * NOW available in Surface Mount.
- * Low profile 7.10mm (0.280").
- * Choice of alignment post.
- * Dual beam contacts offer ultimate performance.

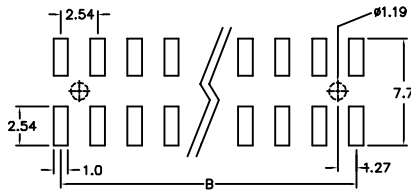
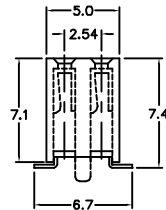
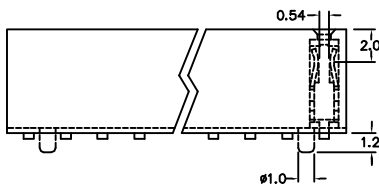
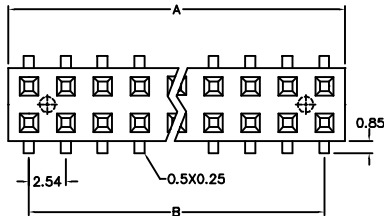

P.C. Board Layout

Position	4 Thru 80
Dimension	
A	2.54 X No. of Positions / 2
B	2.54 X No. of Positions / 2 - 2.54

Ordering information

PS04- 2 40 1 3 N
 Series Double Row No. of Pin Per Row 1: Gold Plated 3: Surface Mount P: With Post
 2: Tin Plated N: Without Post

* Pick & Place Pad Available Upon Request.